

ECOS - G: Projects - 0323-So Peach - ActiveFolder - Drawings - CD-composite-0323.dwg [Composite Map] February 01, 2008 - 12:42pm gretchen

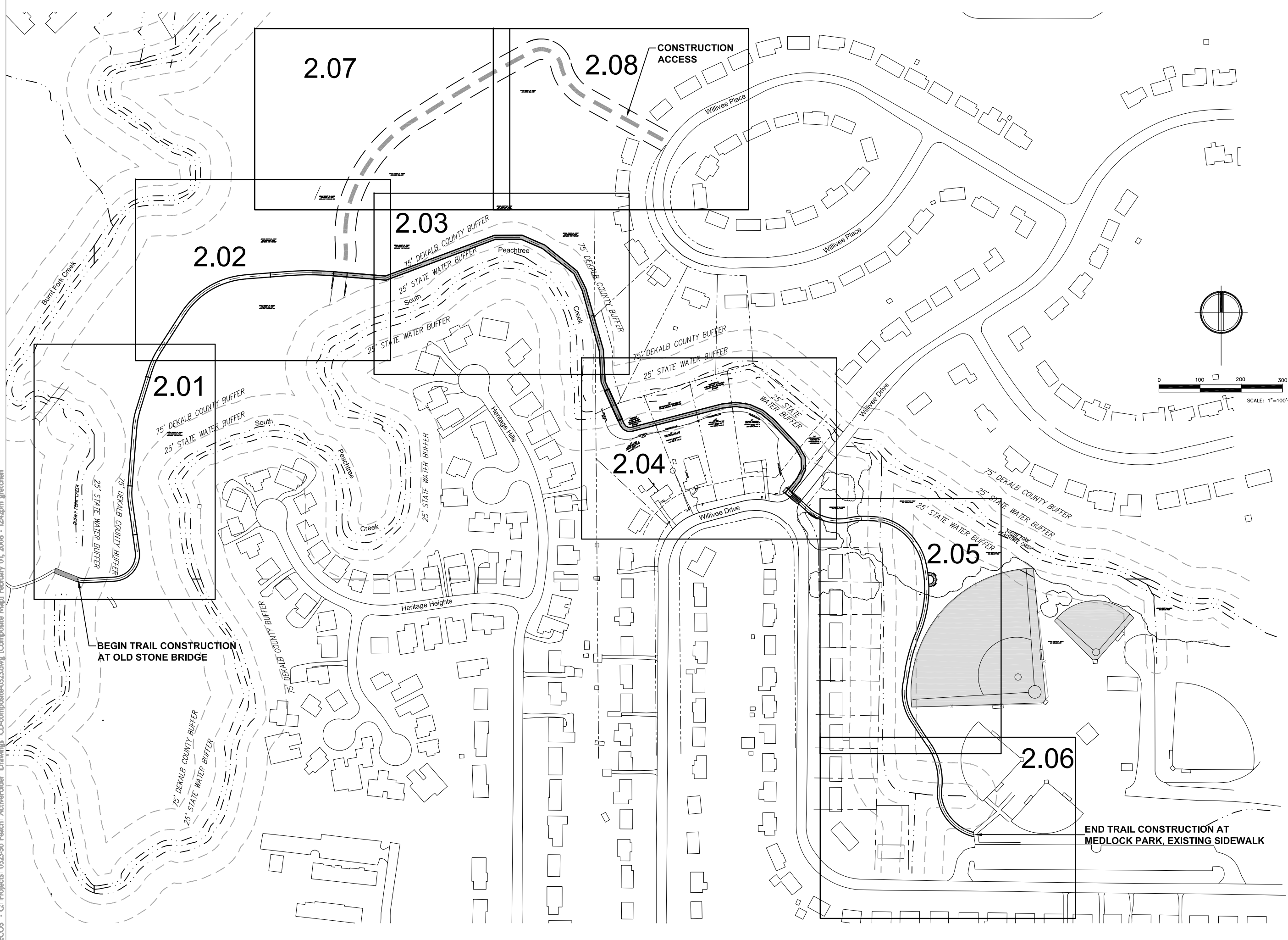

BEGIN TRAIL CONSTRUCTION AT OLD STONE BRIDGE

CONSTRUCTION ACCESS

END TRAIL CONSTRUCTION AT MEDLOCK PARK, EXISTING SIDEWALK

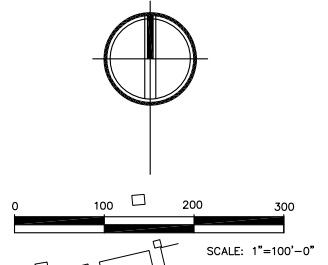

ECOS ENVIRONMENTAL DESIGN, INC.  
 834 Inman Village Parkway  
 Suite 100  
 Atlanta, Georgia 30307  
 (404) 251-9900 (F) 404-251-9111

# South Peachtree Creek Trail

## Burnt Fork Creek Stone Bridge to Medlock Park

Landlots 102 & 103, 18th District - DeKalb Co., Georgia



REVISIONS	
02/08/07	75% CD review set
01/08/08	100% CDs for permit
02/21/08	CD comments

SHEET TITLE  
**Composite Map**

DESIGNED BY Ecos	FILE NAME
DRAWN BY Ecos	SHEET
CHECKED BY KB	<b>CM</b>
PROJECT NO. 0323	
DATE 02/08/07	